

SOUNDPROOFING PRODUCTS

SILENCE IS GOLDEN, ENERGY IS PRECIOUS

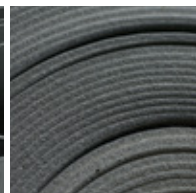
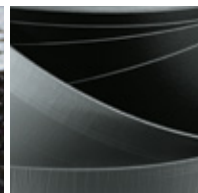

isolmant
acoustic and thermal solutions

CONTENTS

SOUNDPROOFING PRODUCTS

ABOUT ISOLMANT		4
BASICS OF ACOUSTIC INSULATION IN BUILDINGS		6
IMPACT SOUND INSULATION		8
PRODUCTS	Isolmant UnderPlusBlack.E	11
	Isolmant MonoPlus	12
	Isolmant UnderSpecial	13
	Isolmant BiPlus	14
	Isolmant Radiante	15
	Isolmant Fascia perimetrale tecnica doppio spessore	16
	Isolmant Fascia perimetrale Radiante	17
	Isolmant Fascia perimetrale tecnica reticolata	17
	Isolmant Fascia Tagliamuro	18
	Isolmant Fascia Nastro	18
IN-SITU GOOD PRACTICE AND ADVICE		19
AIRBORNE SOUND INSULATION		24
PRODUCTS	Isolmant Fibra LC	26
	Isolmant Perfetto CG	26
	Isolmant Perfetto Special	27
IN-SITU GOOD PRACTICE AND ADVICE		28
SPECIAL PRODUCTS	Isolmant IsolTile	30
	Isolmant TeloGomma	32
REFERENCES		34

ABOUT ISOLMANT

→ LEADER IN ACOUSTIC & THERMAL INSULATION

Since 1976, Isolmant has been a successful player in the construction market: a leader in acoustic & thermal insulation.

Always devoted to develop innovative products for the construction industry, Isolmant made significant efforts to conceive concepts that so far are very renowned.

→ OUR OWN STRENGTHS



**Production and logistics center:
the driving force at Isolmant**

**Daily side by side collaboration with
designers, companies or end-clients**



**Sustainable solutions
and people's well-being**

**Global support: from the design
phase to the final installation**



**Isolmant's Marketing department serves the market
to contribute to the cultural growth in the sector**

**A complete and versatile range of
soundproofing products**



OVER 40 YEARS
OF EXPERIENCE IN THE SECTOR

OVER 70
PRODUCTS IN THE RANGE

7000 m²
OF WAREHOUSE SPACE

20 countries
SERVED WORLDWIDE

OVER 100 million m²
OF HORIZONTAL INSULATION UNDERLAY SOLD

OVER 10
PRODUCT INNOVATIONS INTRODUCED TO THE MARKET



**BREAKDOWN OF
SALES REVENUE
FROM 1980 TO TODAY**

- horizontal insulation
- vertical insulation
- wooden floors
- accessories
- plasterboard

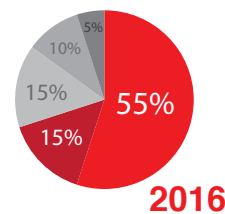

2016

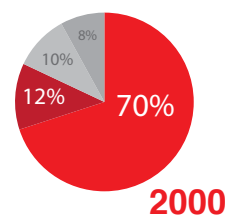

2000

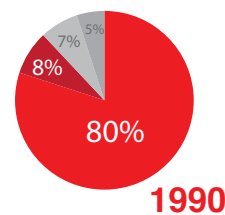

1990

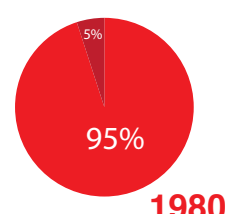

1980

BASICS OF ACOUSTIC INSULATION IN BUILDINGS

The acoustic and thermal insulation of buildings has laid many issues that relate to health, energy consumption and climate changes. In this respect, also the rise of cost of real estate in urban areas and a deeper awareness for sprawling and land consumption have influenced. To date, noise is the fastest growing type of pollution in modern cities, and its effect on our mental and emotional health has a direct influence on our physical well-being – from the lack of sleep to increasing stress. Noise annoyance in buildings, which is caused by sound transmission from adjoining dwellings or from the outside environment, is a crucial concern. Among the problem that beset apartment owners and take first-time high-rise dwellers by surprise, noise is the most common complaint.

Exposure to noise relates to sleep deprivation, annoyance and health issues such as hypertension or heart diseases. Living in block of flats is difficult and with excessive noise which penetrates through windows, floors, ceiling, walls, doors and even through water pipes, this condition becomes extremely unpleasant. But, what could happen if that noise comes from people who live under the same roof?

A sustainable design takes care of health, well-being and privacy. Therefore, innovation, technological systems, as well as the selection of quality insulation materials and their proper installation, could give a great improvement in the quality of life. Different apartments can be built with different standards and Tecnasfalti Isolmant is able to offer sustainable solutions which are featured by insulating materials and the technical expertise for the acoustic and thermal insulation of building.



→ SOUND INSULATION

Sound insulation, otherwise known as sound reduction, is the prevention of sound being transmitted from one part of a building to another, for example by erecting a partition or a wall or installing a floating screed. When considering the sound insulation of constructions, various types of sound may need to be considered: airborne sound, impact sound and flanking sound. There are two basic mechanisms whereby sound can transfer. Noise can pass from one room to another either through the surrounding air (airborne noise) or the building structure itself (structure-borne noise and flanking sound).

→ IMPACT SOUND

Impact sound is generated by direct physical excitation of a part of a building. Examples include slamming doors, stamping on the floor and vibrating washing machines. With impact sound, a relatively small impact can result in a loud sound being transmitted through the structure, often over long distances.

→ AIRBORNE SOUND

Airborne sound sources produce noise by vibrating the air immediately around them. Typical sources include the human voice, musical instruments, home entertainment systems and barking dogs.

→ FLANKING SOUND (SPECIAL/DAMPING PRODUCT)

Flanking sound transmission usually refers to sound that travels through 'flanking' structural elements, such as an external wall that flanks a separating element between two dwellings. Flanking sound can also include sound that travels along unintended air paths, such as unsealed gaps in the structure and around service penetrations.



→ SOLUTIONS, NOT A SINGLE PRODUCT

The floating screed is a technological system (not a single product but a system) to provide impact and airborne sound insulation. It consists of a load bearing layer (screed and finishing) completely disconnected from the other building elements (partitions, surrounding walls, floors and plants or installations) through a resilient separating layer of Isolmant.

Floating screed system

The floating screed construction is made of screed and finishing that are being separated from the surrounding structures by both a horizontal resilient layer (Isolmant sheets) and vertical flanking strips.

This “resilient container” should be continuous and perfectly sealed to avoid any residual or accidental rigid connection between the screed and the supporting floor, as that would negatively affect the acoustic performance of the system (Figure 1).

A floating screed system, acting as a mass/spring/mass system, is the ideal solution for impact sound insulation and to improve airborne sound protection. The screed is designed in order to obtain “mass” over the resilient layer. This latter is acting as a “spring” producing a mitigation effect transforming all vibration and sound into micro movements of the upper floating screed.

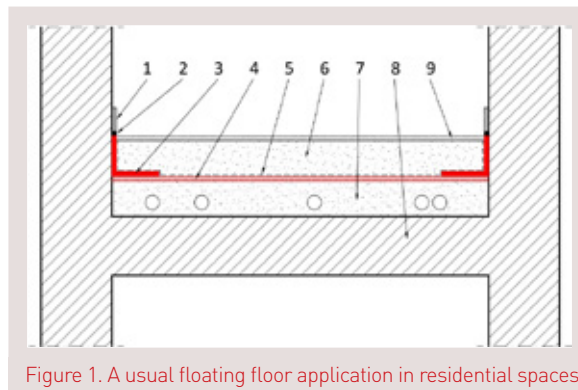

- 1 - Skirting board
- 2 - Elastic joint
- 3 - Flanking strip
- 4 - Resilient material
- 5 - Moisture/vapour barrier (if necessary)
- 6 - Screed
- 7 - Levelling screed
- 8 - Base slab
- 9 - Finishing (ceramic tiles or wooden floor)

Figure 1. A usual floating floor application in residential spaces

The floating screed can be directly laid on the base slab (Figure 2) or alternatively on the levelling screed (Figure 3). If the floating screed is installed on the base slab, service plants and pipes can interrupt flanking strips (figure 5) generating rigid connection and loss of acoustic insulation. Installation on plants and pipes in a levelling layer (figure 4) is preferred because it is easier and more logical to implement, and thereby less prone to workmanship variability. Good to consider all the key aspects such as flanking transmission.

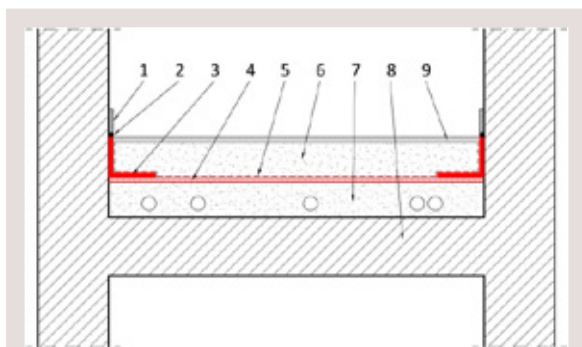

Figure 2. Floating screed installed on the levelling screed

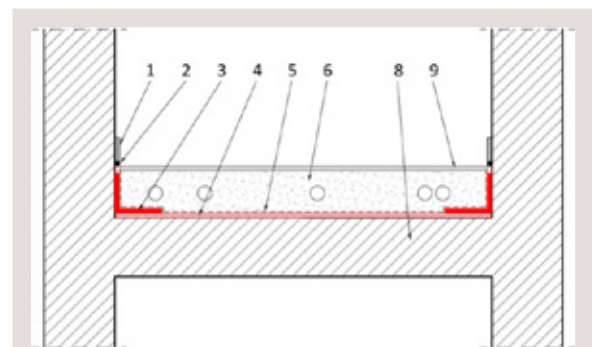

Figure 3. Floating screed installed on the base slab

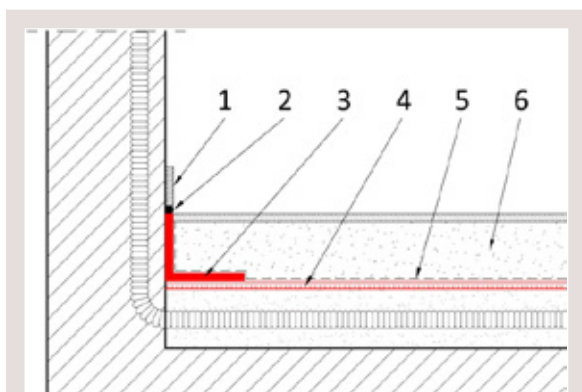

Figure 4. Services installed in the levelling screed do not interrupt flanking strips

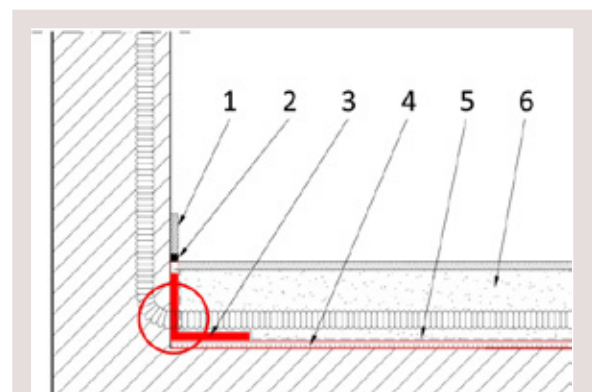



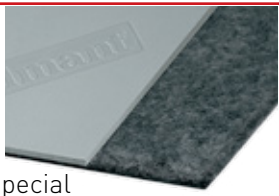

Figure 5. Services installed on the resilient layer in the finishing screed interrupt flanking strips

→ ONE PRODUCT FOR EVERY SITUATION

For a professional and efficient acoustic insulation, Isolmant proposes two types of products that are designed to fit for the different construction conditions. Isolmant defines these ranges as non-coated products, for a basic construction condition (e.i. a floating screed installed on the levelling screed or conditions in which no particularly resistant product is required), and coated products in case resistant products are needed (i.e. when plants and pipes are installed over the resilient material). Each category comprises an entry-level product and a high-performance one. In addition, Isolmant provides some coated products that are specifically conceived for under-floor heating.

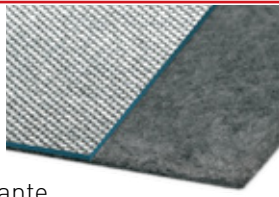

PRODUCTS AND APPLICATIONS

	NON COATED	COATED
BASIC PRODUCT	 UnderPlus Black.E	 MonoPlus
HIGH PERFORMING PRODUCT	 UnderSpecial	 BiPlus
SPECIAL APPLICATION		 Radiante

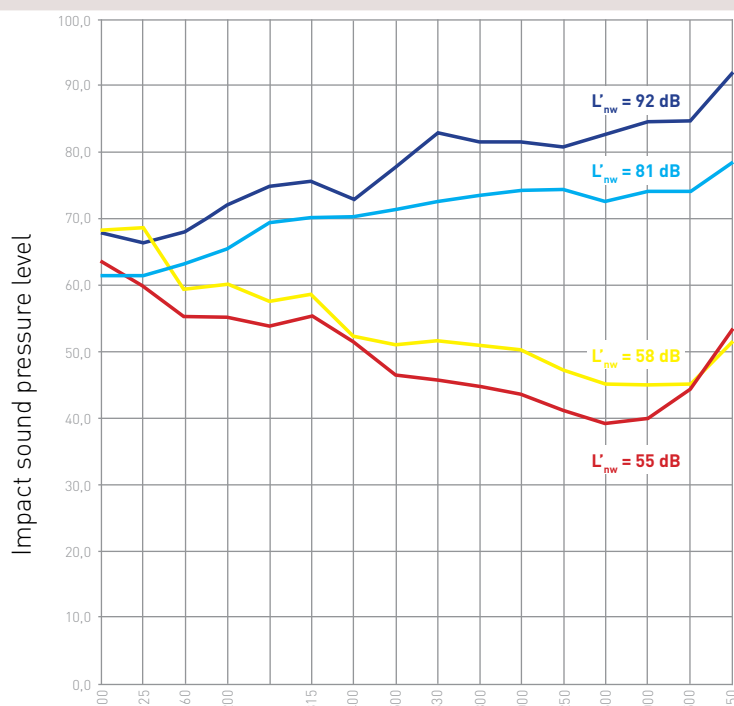

- hollow clay floor
- bounded screed
- floating floor with Isolmant MonoPlus or Isolmant UnderPlus Black.E
- floating floor with Isolmant BiPlus or Isolmant UnderSpecial

Figure 6. Through the frequency spectrum, the figure above shows how a floating screed with Isolmant MonoPlus or Isolmant UnderPlus Black.E (yellow line) or Isolmant BiPlus or Isolmant UnderSpecial (red line) can improve impact sound insulation of a bare hollow clay slab (blu line) or a traditional bounded screed (cyan line).

→ PRODUCTS AND APPLICATIONS

Needs	Technical solution	Construction technique	Recommended product and accessories
Airborne and impact sound insulation of floors	Floating screed comprising a resilient layer under cementitious screed	Resilient material laid on levelling screed	UnderPlus Black.E Fascia Nastro Fascia Perimetrale Tecnica Reticolata Fascia Tagliamuro
		Resilient material laid on base slab (installation of services in the screed)	MonoPlus Fascia Perimetrale Tecnica Reticolata Fascia Tagliamuro
High performance airborne and impact sound insulation of floors	Floating screed with a resilient layer under cementitious screed	Resilient material laid on levelling screed	UnderSpecial Fascia Nastro Fascia Perimetrale Tecnica Doppio Spessore Fascia Tagliamuro
		Resilient material laid on base slab (installation of services in the screed)	BiPlus Fascia Perimetrale Tecnica Doppio Spessore Fascia Tagliamuro
Special application with heating and cooling underfloor system	Floating heating screed	Resilient material under castellated panel	Radiante Nastro Telato Fascia Perimetrale Tecnica Doppio Spessore Fascia Tagliamuro





→ ISOLMANT UNDERPLUS BLACK.E

→ NON-COATED

Product made of a cross-linked closed-cell polyethylene foam layer about 2,5 mm thick, joined on the underside to FIBTEC XF1.E (special needled fibre produced according to technical specifications and designed to provide optimum noise reduction).

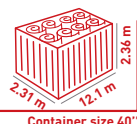
→ To be positioned with the fibre side facing down.

THICKNESS	Approx. 7 mm
IMPACT SOUND INSULATION	$\Delta L_w = 26$ dB Value certified according to UNI EN ISO 140/8
DYNAMIC STIFFNESS	$s' = 19$ MN/m ³ Value tested according to current standards UNI EN 29052/1
THERMAL RESISTANCE	$R_t = 0.171$ m ² K/W
SIZE	Rolls of: 1.50 m x 50 m (h x L) = 75 m ² Product with overlaps Once overlapped, the sheets should be sealed by means of Isolmant Fascia Nastro or Isolmant Nastro Telato
PACKAGING	Single rolls
TRANSPORT DATA	Roll size 1.60 m x 50 m (h x L) = 80 m ² Ø 0.66 m - weight 25 kg - volume 0.7 m ³ n. 82 = 6150 m² n. 38 = 2850 m²    Container size 40" Container size 20"

→ Conditions of use

Isolmant UnderPlus Black.E guarantees high impact noise insulation and also high quality airborne noise reduction. Isolmant UnderPlus Black.E is particularly suitable for two-layer structures, with the floating screed installed on the levelling layer. It requires finishing screed thickness of at least 5 cm; for lower thickness it is recommended to reinforce the screed with suitable mesh or fibre. Care must be taken when applying with "freshly" laid ceramic floor.



→ ISOLMANT MONOPLUS

→ COATED

Product made of 3 mm Isolmant with the upper side bonded to FIBTEC XT2 (screen printed anti-tearing fibre) and the lower side to FIBTEC XS1 (special needle-punched fibre produced according to technical specifications, designed to provide a high quality impact sound insulation).

→ To be positioned with the screen-printed fabric facing upwards.

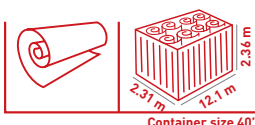
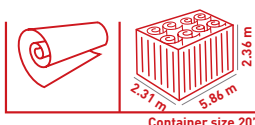
	 isolmantMonoPlus™
THICKNESS	Approx. 6 mm
IMPACT SOUND INSULATION	$\Delta L_w = 28 \text{ dB}$ Value calculated according to EN ISO 12354-2
DYNAMIC STIFFNESS	$s' = 19 \text{ MN/m}^3$
THERMAL RESISTANCE	$R_t = 0.171 \text{ m}^2\text{K/W}$
SIZE	Rolls of: 1.50 m x 50 m (h x L) = 75 m ² This product comes with adhesive flap to seal the overlapping fabric
PACKAGING	Single rolls
TRANSPORT DATA	Roll size 1.60 m x 50 m (h x L) = 80 m ² Ø 0.65 m - weight 35 kg - volume 0.633 m ³ <div style="display: flex; justify-content: space-around; align-items: flex-end;"> <div style="text-align: center;"> <p>n. 82 = 6150 m²</p>  <p>Container size 40'</p> </div> <div style="text-align: center;"> <p>n. 38 = 2850 m²</p>  <p>Container size 20'</p> </div> </div>

→ Conditions of use

Isolmant MonoPlus is recommended for impact sound insulations with floating screed. It is also suitable for single-layer application when the direct installation of building plants on the resilient layer requires tear resistance and protection to avoid damaging the insulating material. The product can be installed with low thickness screed (at least 5 cm).

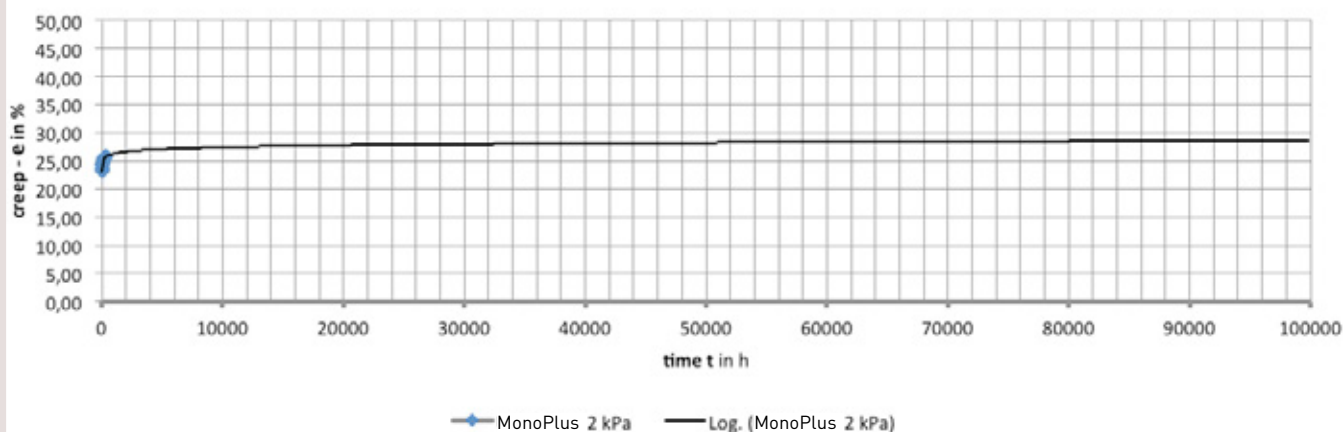

Isolmant MonoPlus long term compressive creep behaviour under a static load of 2 kPa

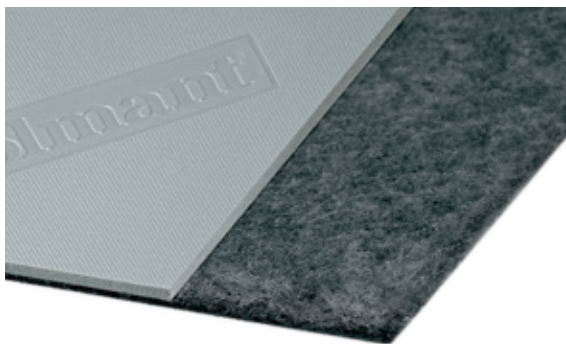

→ ISOLMANT UNDERSPECIAL

→ NON-COATED

Product made of 5 mm Isolmant Special with the lower side bonded to FIBTEC XF1 (special needle-punched fibre produced according to technical specifications, conceived to provide a high quality noise reduction).

→ To be positioned with the fibre side facing down.

		isolmantUnderSpecial™
THICKNESS	Approximately 8 - 13 mm	
IMPACT SOUND INSULATION	$\Delta L_w = 34$ dB	
DYNAMIC STIFFNESS	$s' = 11$ MN/m ³	
THERMAL RESISTANCE	$R_t = 0.234$ m ² K/W	
SIZE	Rolls of: 1.50 m x 50 m (h x L) = 75 m ² (Version 9 mm) 1.50 m x 25 m (h x L) = 37,5 m ² (Version 13 mm) Product with overlaps Once overlapped, the sheets should be sealed by means of Isolmant Fascia Nastro or Isolmant Nastro Telato	
PACKAGING	Single rolls	
TRANSPORT DATA	<div> <div>Version 9 mm:</div> <div>Roll size 1.60 m x 50 m (h x L) = 75 m²</div> <div>Ø 0.73 m - weight 25.6 kg - volume 0.85 m³</div> <div>Version 9 mm → n. 71 = 5325 m² n. 35 = 2625 m²</div> <div>Version 14 mm → n. 88 = 3300 m² n. 40 = 1500 m²</div> <div> <div>Container size 40"</div> </div> <div> <div>Version 13 mm:</div> <div>Roll size 1.60 m x 25 m (h x L) = 37,5 m²</div> <div>Ø 0.66 m - weight 19,25 kg - volume 0.697 m³</div> <div> <div>Container size 20"</div> </div> </div> </div>	

→ Conditions of use

Isolmant UnderSpecial ensures high impact sound insulation in floating screed application. It is suitable when a higher airborne sound insulation is required. In particular, this product is recommended in double-layer application. It needs a 6 cm screed. Screeds with lower thickness should be reinforced by means of a suitable metal mesh or fibres. Attention must be paid in case of dry shake installation of ceramic tiles.

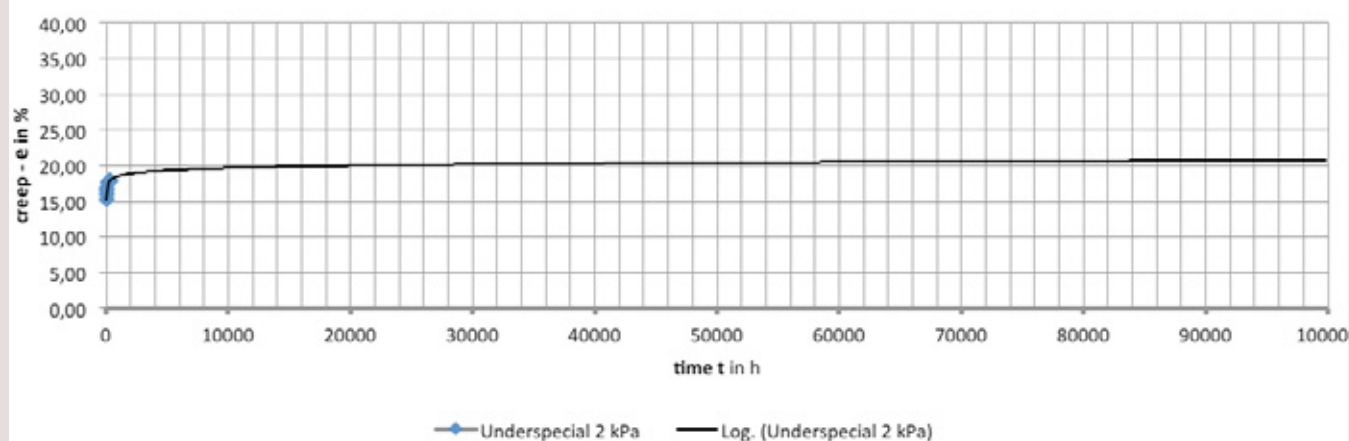

Isolmant UnderSpecial long term compressive creep behaviour under a static load of 2 KPa

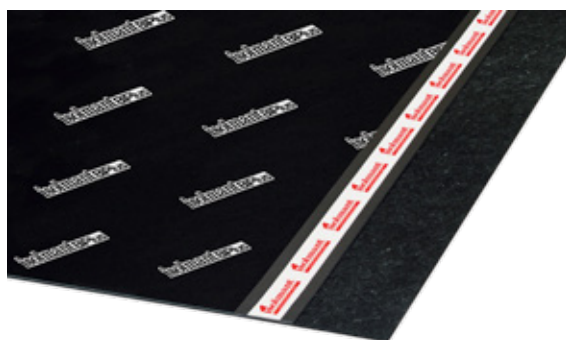

→ ISOLMANT BIPLUS

→ COATED

Product made of 5 mm Isolmant with the upper side bonded to FIBTEC XT1 (screen-printed anti-tearing fibre) and the lower side to FIBTEC XF1 (special needle-punched fibre produced according to technical specifications, conceived to provide a high quality noise reduction).

→ To be positioned with the screen-printed fabric facing upwards.

		isolmantBiPlus™
THICKNESS	Approx. 9 - 14 mm	
IMPACT SOUND INSULATION	$\Delta L_w = 34$ dB Certified value	
DYNAMIC STIFFNESS	$s' = 11$ MN/m ³	
THERMAL RESISTANCE	$R_t = 0.260$ m ² K/W	
SIZE	Rolls of: 1.50 m x 50 m (h x L) = 75 m ² (Version 9 mm) 1.60 m x 25 m (h x L) = 37,5 m ² (Version 14 mm) This product comes with a top adhesive profile to seal the overlapping flaps	
PACKAGING	Single rolls	
TRANSPORT DATA	<div> <div>Version 9 mm:</div> <div>Roll size 1.50 m x 50 m (h x L) = 75 m²</div> <div>Ø 0.75 m - weight 42 kg - volume 0.9 / 1 m³</div> </div> <div> <div>Version 14 mm:</div> <div>Roll size 1.60 m x 25 m (h x L) = 37,5 m²</div> <div>Ø 0.70 m - weight 22,7 kg - volume 0.78 / 1 m³</div> </div> <div> <div>Version 9 mm → n. 69 = 5175 m² n. 34 = 2550 m²</div> <div>Version 14 mm → n. 71 = 2662 m² n. 35 = 1312 m²</div> </div> <div> <div> <div>Container size 40"</div> </div> <div> <div>Container size 20"</div> </div> </div>	

→ Conditions of use

Isolmant BiPlus is recommended for high impact sound insulations with floating screed. It is also suitable for single layer application when the direct installation of building plants on the resilient layer requires tear resistance and protection to avoid damaging the insulating material. It needs at least a 6 cm screed. Screeds with lower thickness should be reinforced by means of a suitable metal mesh or fibres. Attention must be paid in case of dry shake installation of ceramic tiles.

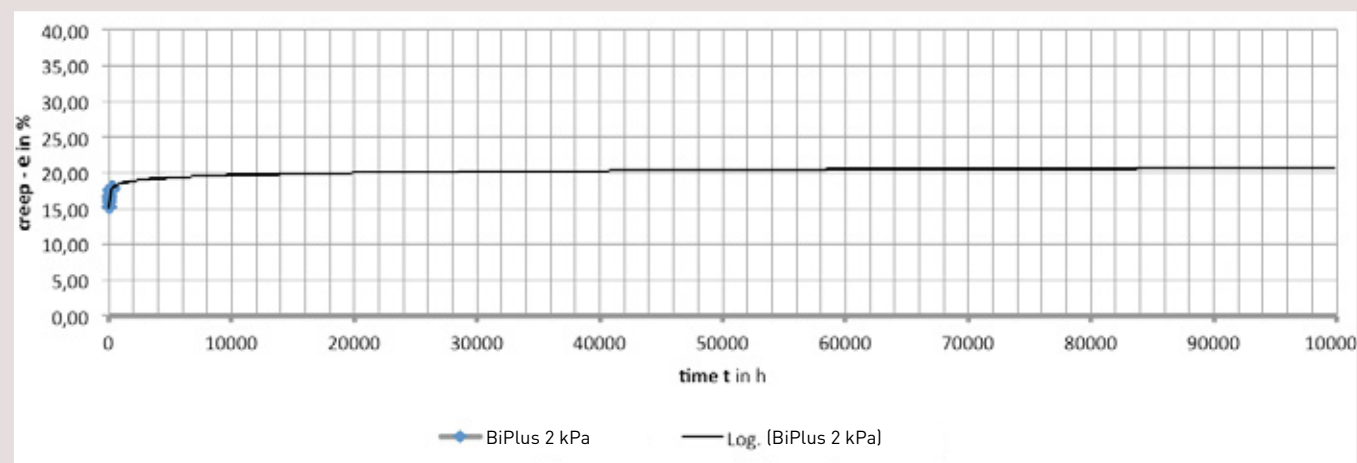

Isolmant BiPlus long term compressive creep behaviour under a static load of 2 KPa

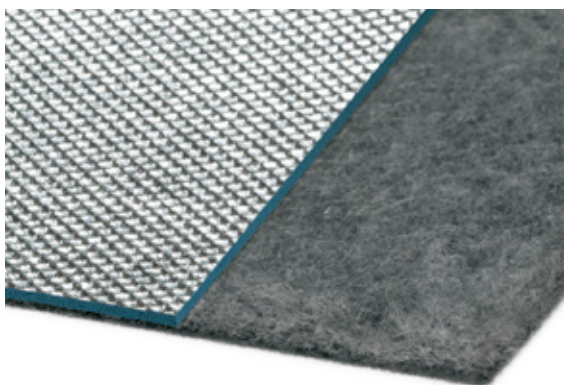

→ ISOLMANT RADIANTE



→ COATED

Product made of 2 mm HD Isolmant Special with the upper side bonded to a radiant, embossed aluminate coated film and the lower side bonded to FIBTEC XF2 (special needle-punched fibre produced according to technical specifications, designed to provide a high quality noise reduction).

→ To be installed with the aluminate-coated side facing upwards.

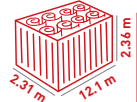

isolmantRadiante™

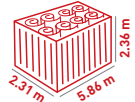
THICKNESS	Approx. 5 mm - 8 mm
IMPACT SOUND INSULATION	$\Delta L_w = 25 \text{ dB}$ (version 5 mm) Value certified according to the EN ISO 140/8 $\Delta L_w = 30 \text{ dB}$ (version 8 mm) Value certified according to the EN ISO 12354-2 e UNI/TR 11175
DYNAMIC STIFFNESS	$s' = 21 \text{ MN/m}^3$ (version 5 mm) $s' = 15 \text{ MN/m}^3$ (version 8 mm)
THERMAL RESISTANCE	$R_t = 0.168 \text{ m}^2\text{K/W}$ (version 5 mm) $R_t = 0.254 \text{ m}^2\text{K/W}$ (version 8 mm)
SIZE	Rolls of: $1.50 \text{ m} \times 50 \text{ m}$ (h x L) = 75 m^2 (version 5 mm) $1.50 \text{ m} \times 25 \text{ m}$ (h x L) = $37,5 \text{ m}^2$ (version 8 mm) Product with overlaps Once overlapped, the sheets should be sealed by means of Isolmant Nastro Telato or Isolmant Fascia Nastro
PACKAGING	Single rolls
TRANSPORT DATA	Version 5 mm: Roll size $1.60 \text{ m} \times 50 \text{ m}$ (h x L) $\emptyset 0.55 \text{ m}$ - weight 27 kg - volume 0.484 m^3 Version 8 mm: Roll size $1.60 \text{ m} \times 25 \text{ m}$ (h x L) = $37,5 \text{ m}^2$ $\emptyset 0.54 \text{ m}$ - weight 15 kg - volume 0.467 m^3 Version 5 mm → n. 118 = 8850 m² n. 56 = 4200 m² Version 8 mm → n. 118 = 4225 m² n. 56 = 2100 m² <div style="display: flex; justify-content: space-around; align-items: flex-end;"> <div style="text-align: center;">   <p>Container size 40"</p> </div> <div style="text-align: center;">   <p>Container size 20"</p> </div> </div>

→ Conditions of use

Isolmant Radiante is specific for applications with underfloor heating or cooling systems. Thanks to its aluminate reflective film, it can block any downward loss of heat. This product fits for low thickness screed installations with thin thermal insulation panels. An acoustic resilient layer is always required, because thermal panels do not provide acoustic insulation (except in specific cases).

→ ISOLMANT **FASCIA PERIMETRALE TECNICA DOPPIO SPESSORE**

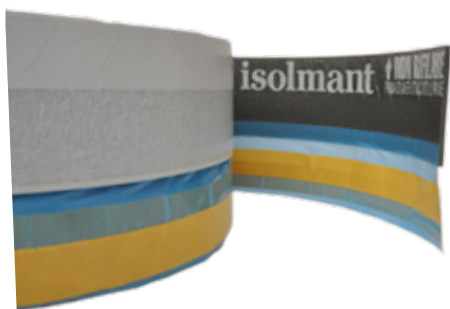

Adhesive perimeter strips designed for an easy installation. They have a vertical part made of expanded cross-linked polyethylene with 5 mm thickness. This side is partially adhesive and it is conceived to be installed on the wall. The horizontal part is made of an HDPE film with 0.1 mm thickness and silicone adhesive paper on both sides. These strips come with a screen-printed side with installation instructions. This product is available in two versions:

- h 20 cm (12.5 cm wall + 7.5 cm floor);
- h 25 cm (17.5 cm wall + 7.5 cm floor).



isolmant FasciaPRM

THICKNESS	Approx. 5 mm (vertical part) - approx. 0.1 mm (horizontal part)
FLANKING PATH NOISE REDUCTION	Avoiding the installation of Isolmant Fascia Perimetrale causes an acoustic bridge and a consequent decibel loss
INSTALLATION	Due to its silicone adhesive paper film on both sides, Isolmant Fascia Perimetrale Tecnica doppio spessore is suitable for installation under or over the resilient layer. Trim the extra length only after laying and grouting tiles and before installing the skirting boards.
SIZE	20 - 25 cm x 50 m strips
PACKAGING	4 rolls equal to 200 m
TRANSPORT DATA	Roll size (Strip h 20 cm) Ø 0.56 m - weight 12 kg - volume 0.25 m ³ Roll size (Strip h 25 cm) Ø 0.56 m - weight 14 kg - volume 0.31 m ³

→ **Conditions of use**

In order to ensure floating flooring acoustic performances, the vertical surfaces of the screed should also be disconnected from surrounding building elements. In addition, as an alternative to turn up and bend the resilient layer along the edges of the floating screed (which is sometimes difficult during installation), it is possible to apply Isolmant Fascia Perimetrale along the room perimeter.

→ISOLMANT FASCIA PERIMETRALE RADIANTE



Vertical strips made of expanded closed-cell cross-linked polyethylene with 15 cm height. These strips have a 10 cm of reusable adhesive flap to overlap the radiant panel starting from the lower edge. In addition, the strips are screen-printed with installation instructions.

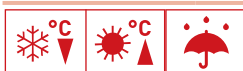

isolmant FasciaPRM

THICKNESS	Approx. 8 mm
FLANKING PATH NOISE REDUCTION	Vertical strips made of expanded closed-cell cross-linked polyethylene with 15 cm height. These strips have a 10 cm of reusable adhesive flap to overlap the radiant panel starting from the lower edge. In addition, the strips are screen-printed with installation instructions.
INSTALLATION	<ul style="list-style-type: none"> • Use the replaceable adhesive side to connect the flanking strip to the wall • The strip should be very well connected to the acoustic resilient layer • Use the heating pipes to fix the polyethylene layer, which extends from the strip, to the thermal panel • Lay the thermal panel on the strip avoiding any physical gap in which any concrete material could end • Trim the extra length only after laying and grouting the tiles and before installing the skirting boards
SIZE	Strips of 15 cm x 25 m
PACKAGING	10 rolls equal to 250 m
TRANSPORT DATA	Roll size Ø 0.50 m - weight 14,3 kg - volume 0.388 m³

→Conditions of use

Isolmant Fascia Perimetrale Radiante avoids flanking noise and vibration transmission from floating screed to the partition wall. To ensure the proper functioning of the floating floor it is necessary that the whole system resting on the resilient layer could move freely. Flanking strips avoid any rigid contacts between the screed and walls, pillars and façades. It can substitute the elastic material used for expansion joints. In case of underfloor heating systems, Isolmant Fascia Perimetrale Radiante can be used as expansion joint and thermal break.

→ISOLMANT FASCIA PERIMETRALE TECNICA RETICOLATA



Expanded cross-linked closed-cell polyethylene strips designed for easy installation. These strips come with a screen-printed side with installation instructions.

This product is available in three versions:

- h 12.5 cm (7.5 cm wall + 5 cm floor);
- h 18.5 cm (11 cm wall + 7.5 cm floor);
- h 25 cm (17.5 cm wall + 7.5 cm floor).



isolmant FasciaPRM

THICKNESS	Approx. 5 mm
FLANKING PATH NOISE REDUCTION	Avoiding the installation of Isolmant Fascia Perimetrale causes an acoustic bridge and a consequent decibel loss
INSTALLATION	<p>After removing the protection film of the adhesive side, Isolmant Fascia Perimetrale should be installed on the floor (or the resilient layer already positioned) and then to the wall.</p> <p>The extra length must be trimmed with a "snap-off blade" utility knife after completing flooring installation and finishing.</p>
SIZE	12.5 - 18.5 - 25 cm x 50 m strips
PACKAGING	Version h 12.5 cm: 12 rolls equal to 600 m Version h 18.5 cm: 8 rolls equal to 400 m Version h 25 cm: 6 rolls equal to 300 m
TRANSPORT DATA	Roll size Ø 0.53 m - weight 16 kg - volume 0.421 m³

→Conditions of use

In order to ensure floating floor performances, the vertical surfaces of the screed should also be insulated. In addition, as an alternative to turn up and bend the resilient layer along the edges of the floating screed (which is sometimes difficult during installation), it is possible to apply Isolmant Fascia Perimetrale along the room perimeter. Designed for easy installation, this flanking strip ensures a high-level of acoustic performance.

→ ISOLMANT **FASCIA TAGLIAMURO** STANDARD/STRONG



10/15/30 cm underwall bearing strips made of HD Isolmant for the acoustic insulation of hollow brick masonry. This product is available as Standard (density approx. 50 kg/m³, suitable for light hollow brick masonry) and Strong version (density approx. 70 kg/m³ suitable for heavy hollow brick masonry).



isolmant FasciaTGM

THICKNESS	Approx. 4 mm (Standard version) Approx. 6 mm (Strong version)
FLANKING PATH NOISE REDUCTION	Enhance the impact sound insulation of the wall
MECHANICAL FEATURES	<p>Standard 50 kg/m³ Strong 70 kg/m³</p> <p>TENSILE STRENGTH: Longitudinal: kPa 675 kPa 835 Cross: kPa 465 kPa 735</p> <p>COMPRESSIVE STRENGTH: 10% compression: kPa 30 kPa 85 25% compression: kPa 55 kPa 115 50% compression: kPa 125 kPa 185</p> <p>COMPRESSION SET: 22h. load, 23°C, compression at 25% 0.5h. after discharge 16% 8% 25h. after discharge 7% 3%</p>
SIZE	10 - 15 - 30 cm x 50 m strips
PACKAGING	Version h 10 cm: 15 rolls equal to 750 m Version h 15 cm: 10 rolls equal to 500 m Version h 30 cm: 5 rolls equal to 250 m
TRANSPORT DATA	Roll size (Standard strip) Ø 0.5 m - weight 16.4 kg - volume 0.375 m ³ Roll size (Strong strip) Ø 0.62 m - weight 33 kg - volume 0.578 m ³

→ Conditions of use

Isolmant Fascia Tagliamuro is recommended to disconnect vertical partitions, including the internal partition of the perimeter wall to avoid rigid connections between the building elements. Thanks to its balanced density, Isolmant Fascia Tagliamuro ensures the right mechanical strength (to avoid the cracking of partitions) and the necessary anti-vibration isolation (to avoid acoustic bridges).

→ ISOLMANT **FASCIA NASTRO**



Adhesive strip made of 7.5 cm high Isolmant, suitable for sealing together Isolmant sheets.



isolmant FasciaNastro

THICKNESS	Approximately 3 mm
IMPACT SOUND INSULATION	Avoiding the installation of Isolmant Fascia Nastro causes a decibel loss occurring when Isolmant sheets are not properly sealed.
INSTALLATION	Install Isolmant Fascia Nastro after trimming it with a cutter.
SIZE	Strips of 7.5 cm x 50 m
PACKAGING	4 rolls equal to 200 m
TRANSPORT DATA	Roll size Ø 0.44 m - weight 12 kg - volume 0.277 m ³

→ Conditions of use

Ideal for sealing together Isolmant sheets (especially if they have no adhesive overlapping flaps), thus preventing the passage of noise and humidity. Isolmant Fascia Nastro ensures continuity of both the resilient material and the layer protecting from the risk of humidity. It can also be useful to repair the insulating layer and ensure continuity of the resilient layer to complete the acoustic insulation of the floor before installing the screed.

→ GOOD ACOUSTIC PERFORMANCE NEEDS GOOD PRACTICE

A lack of good practice can lead to workmanship errors. Bad practice and poor workmanship may lead to very different results from those expected in the design phase.

In order to provide acoustically more robust constructions, the knowledge of good and bad practices and the possible influence of workmanship are also of primary importance in the design phase. Good design is easier and more logical to implement, thereby being less prone to workmanship variability. Good workmanship involves thought and care, with an appreciation of key aspects such as flanking transmission.

Floating screed installation process

Poor acoustic performances can result from the lack of a floating floor on the ground floor of multi-storey buildings as well as the lack of a floating floor in row dwellings with a continuous slab connecting each other. Impact sound can also be transmitted horizontally through the slabs and noticed in adjacent rooms. A floating floor should be considered whenever there are quiet rooms, even if they are located on the ground floor. A interruption of the screed is needed to avoid horizontal transmission of impact sound between quiet and busy areas (corridors/bedrooms). To ensure more comfort and privacy it is suggest that the resilient layer should be installed after the partition walls. A base floor directly bearing partition walls (lay Isolmant after installing partitions) enables the creation of a floating screed in each room. It gives the following advantages:

- reduction of the acoustic bridge between the wall and the screed;
- more comfort and privacy between adjoining rooms.

When laying Isolmant products for noise and thermal insulation of horizontal structures, make sure that continuity of resilient material is provided to create a real watertight tank and resilient container, built according to the following main specifications:

1. Dry lay Isolmant resilient material on the hardened concrete slab;
2. Install flanking strips;
3. Plants, pipes and installations (if not laid in the levelling screed);
4. Pour/cast cement screed;
5. Lay finishing surface with adhesive after screed has dried out;
6. Trim the exceeding flanking strips after the flooring has been laid and filled with tile grout.

→ RULES FOR A GOOD USE OF ISOLMANT PRODUCTS

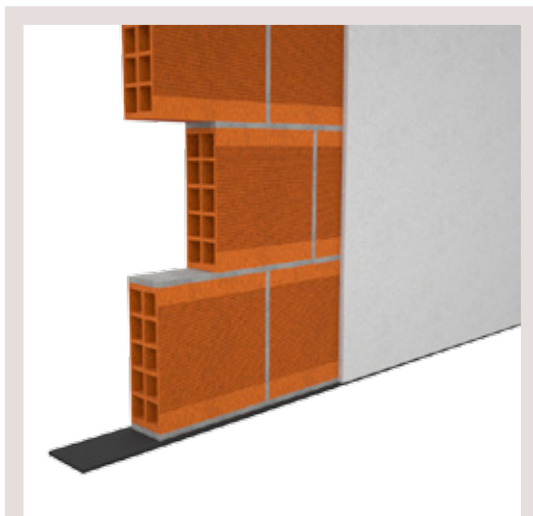

Direct contact between partition wall and slab should be avoided using a resilient layer (Isolmant Fascia Tagliamuro) in order to reduce flanking transmission. This resilient material provides adequate load bearing characteristics maintaining an elastic behaviour under wall weight. Isolmant Tagliamuro can be used only for partition walls (inner or perimetral partition). It should be installed directly over the slab under the first row of mortar.

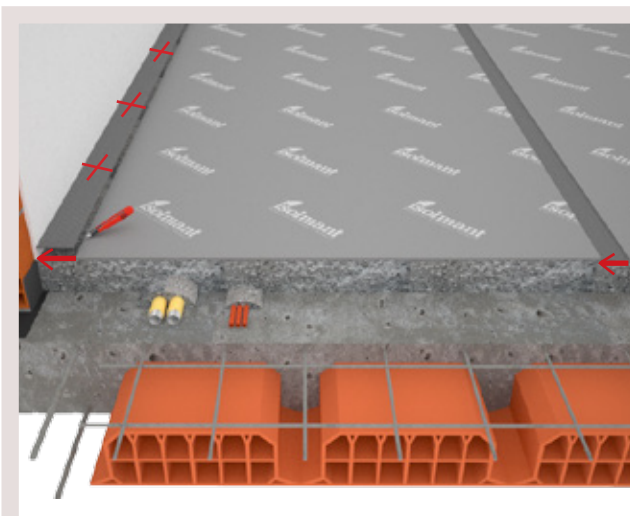

Isolmant products are composed of Isolmant polyethylene foam joined to a special needle-punched fibre manufactured to calibrated specifications for enhanced impact sound insulation. Polyethylene foam and fibre must be always superimposed: the selvage for the overlap must be trimmed flush with the wall.

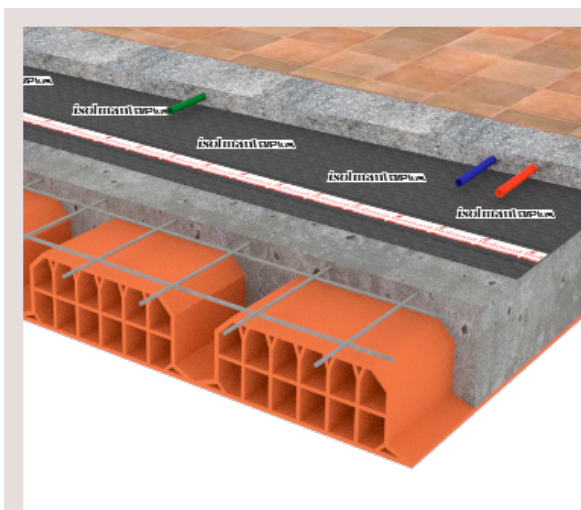

Isolmant covered products are coupled on the top surface with a special tear resistant fabric. Pipes can be installed over Isolmant resilient material (MonoPlus or BiPlus) but they should be fixed with a plot of mortar. No mechanical fixing should be used in order to avoid rigid connection and to maintain integrity of Isolmant sheets.

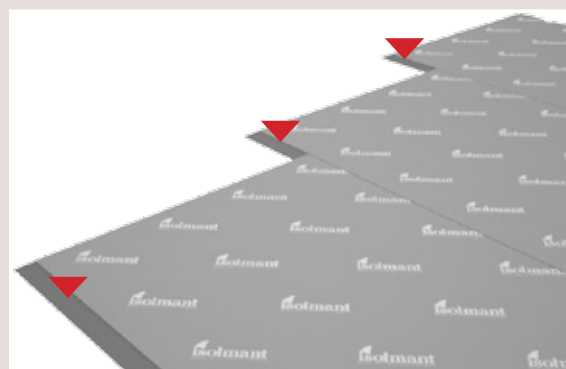

Isolmant MonoPlus and BiPlus products come with a selvage to overlay the sheets, and the adhesive tape to seal above selvage.

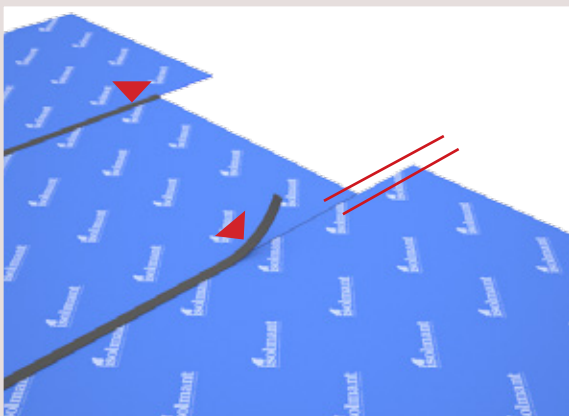
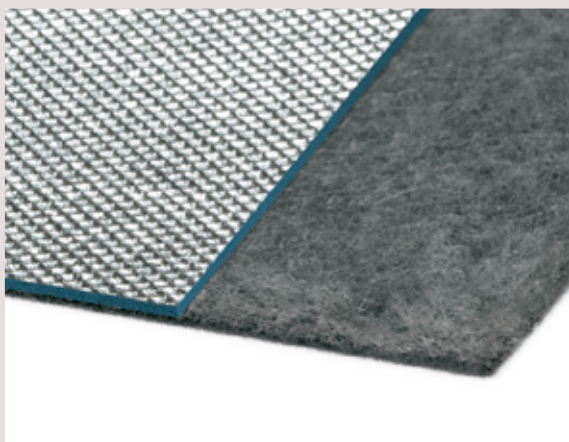

Joints between Isolmant resilient material sheets should be sealed with tape such as Isolmant Fascia Nastro after overlaying the selvedge.

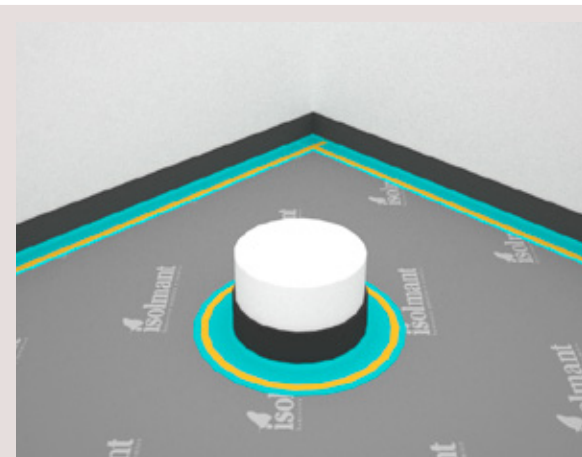

From the technical point of view, the functioning of a floating screed is to guarantee that no connection exists between the screed and any other structural element or building plant. Flanking strips avoid any rigid contacts between the screed and the surrounding walls, pillars and façades.

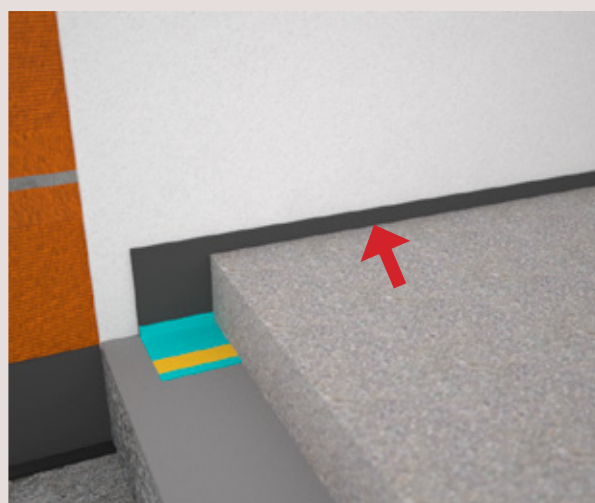
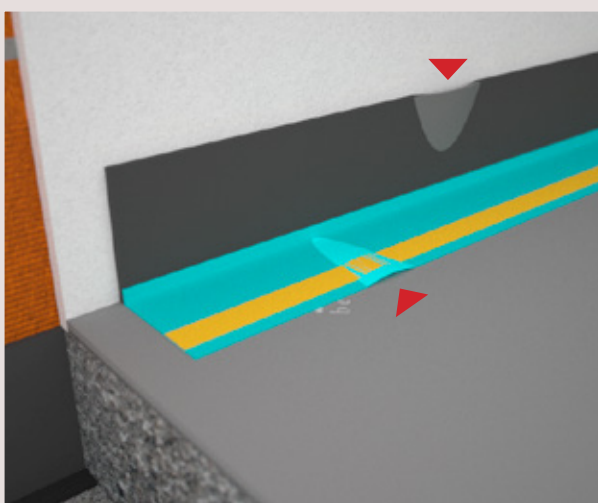

Flanking strips must be placed in the joint between the screed and the surrounding walls, trapped to the wall and horizontally sealed above or below the Isolmant sheet. It is necessary to avoid the formation of air bubbles while applying the strip. Strip height should exceeds screed thickness, including floor finishing such as tile or wood.

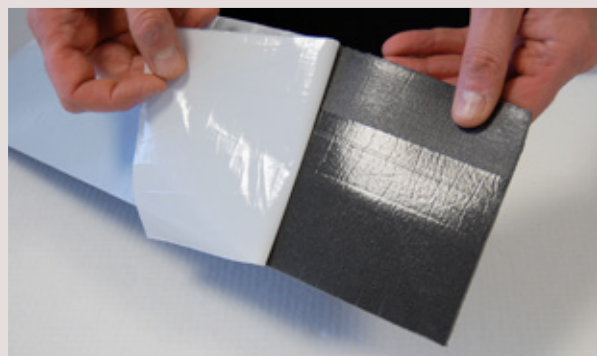

The pre-moulded polyethylene flanking strip enables a faster laying of the product and reduces construction time. When applying the adhesive to the vertical part on the wall, the flanking strip should be bent into L shape taking care that it perfectly adhere both horizontally and vertically.



In the corners, strips must be bent at 90 degrees avoiding any curve. That will prevent installation errors and the formation of acoustic bridges. If the material does not completely adhere to the edge, the screed could be damaged or broken. In this points, the air bubble reduces thickness and mechanical strength of the screed, so it should be avoided in order to ensure a good noise isolation.



The exceeding flanking strip should be trimmed only after that the flooring has been laid and filled with tile grout.

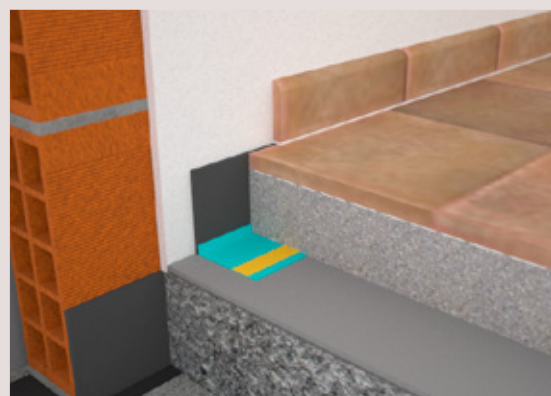

To guarantee proper operation of the floating floor, it is necessary that the entire system resting on the underlay can move freely. This is why it is also essential that the skirting board is disconnected from the surface finish of the floor. The rigid connection caused by grouting the skirting board with mortar might result in a loss of impact noise insulation of many decibel.

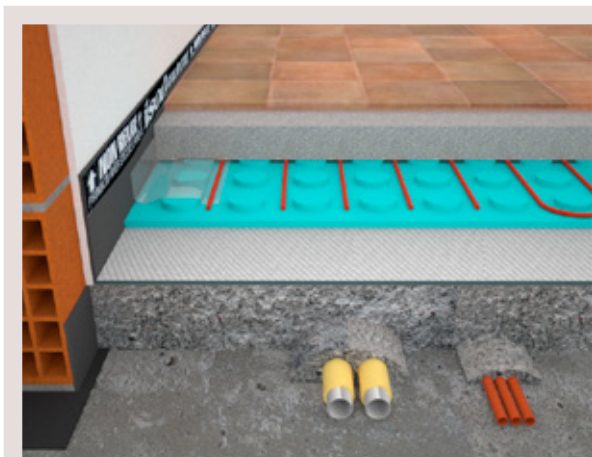

Standard castellated panels do not provide impact sound insulation, consequently it should be pointed out that a resilient acoustic layer is always required to ensure compliance with acoustic requirements. Isolmant resilient mat can be installed under panel of underfloor heating system.

To ensure the proper functioning of the floating floor it is necessary that the whole system resting on the resilient layer could move freely. Flanking strips avoid any rigid contacts between the screed and walls, pillars and façades.

Special edging insulation strips fulfill two important functions. Prevent acoustic bridges around the border joints whilst providing sufficient freedom of movement to the screed (at least 5 mm) in compliance with standard specifications and the manufacturer's specifications for self-leveling screed.



Isolmant supplies the special edging insulation strips in two versions:

- Fascia Perimetrale Radiante. This strip comes with a polyethylene flap to overlap the castellated underfloor insulation panels. The foil should be pressed into the first row of studs and then fixed by pipe.
- Fascia Perimetrale Tecnica Doppio Spessore. For self-leveling screed additionally features foil with an adhesive strip on both sides to provide improved sealing of border joints.

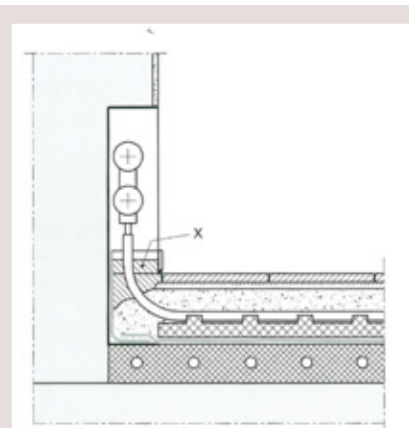
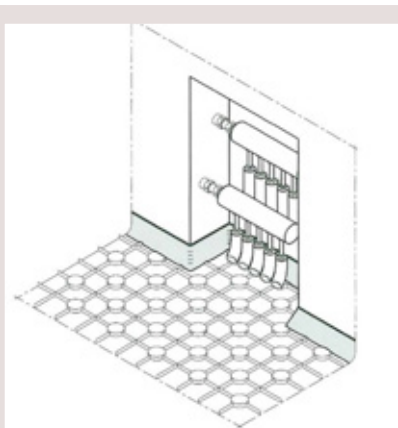
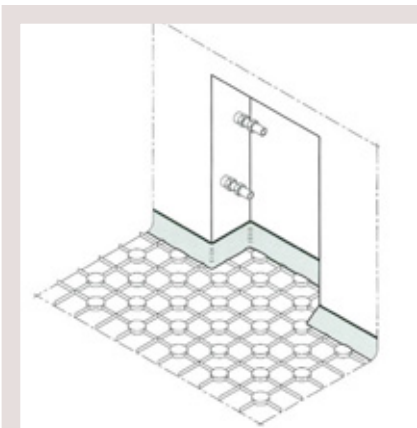

Special attention should be paid to acoustic insulation of manifold cabinet. Any rigid connection must be avoided: flanking strips must be installed running along the inner perimeter of flush-mounting manifold cabinets. Resilient mat should butt up against the perimeter isolation strip snugly even in the depth of manifold cabinet

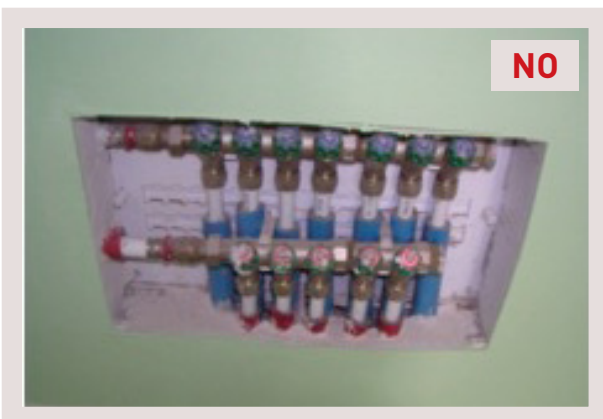

→ AIRBORNE NOISE INSULATION SYSTEM

Improving the sound insulation performance of a separating wall between dwellings is the main way thought which airborne noise can be reduced. The acoustic design of the partition wall between dwellings should ensure adequate comfort and privacy to users.

When designing the separating walls, there are two main aspects to be considered:

- choosing the right partition to meet users' requirements and real needs;
- designing the right junction details to avoid or minimize flanking transmission.

In addition to users' needs of acoustic insulation, a structure with the right sound insulation properties should also fulfil space and construction type requirements.

Separating walls can be single heavy walls, cavity walls, light steel frame walls, etc., and each of these construction types needs different skills and care.

→ HEAVY WALLS

Heavy single walls

This type of wall comprises concrete or limestone blocks with a weight of 400 to 575 kg/m².

The insulating acoustic property of heavy walls increases with their mass, according to the law of "+ 6 dB/octave" (mass-frequency law). Lack of insulation occurs in the lower frequency part of the spectrum, in correspondence of the resonance frequency, and in the higher part of the spectrum, at the coincidence frequency (critical frequency).

For blocks and heavy bricks, resonance frequency is very low, and not comprised in the measured frequency spectrum, while the coincidence frequency occurs in the middle frequency part of the spectrum and can significantly affect the sound reduction index of the wall.

Heavy cavity walls

An increase in mass (and thickness) of a single wall is not the only - and the most efficient - way to increase sound insulation: a better solution is a double wall with air gap. If the cavity is filled with fibrous insulating material, this system acts both according to the mass-frequency law, and as a mass-spring-mass model.

Care must be put on wall design, to avoid that both layers have the same resonant frequency.

The level of sound insulation between dwellings using cavity separating walls is highly dependent on the isolation provided by the cavity between the wall leaves: the largest is the cavity, the better is the sound reduction index.

Cavity wall composed of two masonry, hollow bricks, concrete or limestone leaves (ca 200 kg/m²) separated by a cavity at least 40 mm wide should be insulated with a fibrous sound absorbing material to improve airborne sound insulation. This material absorbs the cavity sound field in the inner air gap, and reduces the sound energy flux from the noise source to the receiving side. Sound absorbing material should be installed continuously in the cavity.

→ LIGHT WALLS

Light steel frame walls and false walls

Light steel frame walls or metal stud walls commonly consist of several gypsum-based boards attached to two independent steel frames. They are most commonly used in multistorey developments although they are also popular in refurbishment projects of existing buildings. False walls are also very common to increase acoustic insulation of existing structures.

Sound insulation is most effective when the faces are structurally isolated with resilient material. When the two layers forming the wall cavity do not have rigid connections between them (double frame lightweight wall), the addition of sound absorbing material to the cavity increases the R_w by about 10 points. The sound absorbing material should be placed into the cavity between the steel frame structures and then coated with plasterboard panels.

The mass of plasterboard per unit area is very important in determining airborne sound insulation: the heavier the layers, the better the insulation. Due to handling limitations, multiple layers are often the preferred solution. A layer of insulating material can be installed between two plasterboards in order to reduce the resonance frequency and to improve low frequency insulation performances. Joints should be staggered in multiple layer applications.

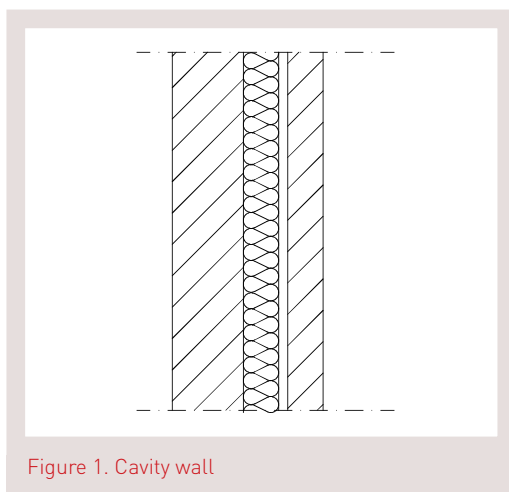

Figure 1. Cavity wall

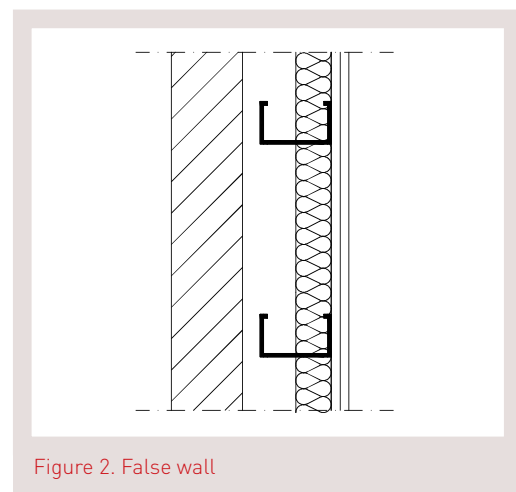

Figure 2. False wall

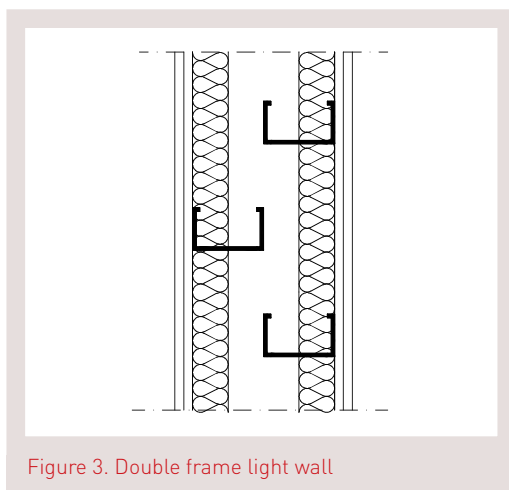

Figure 3. Double frame light wall

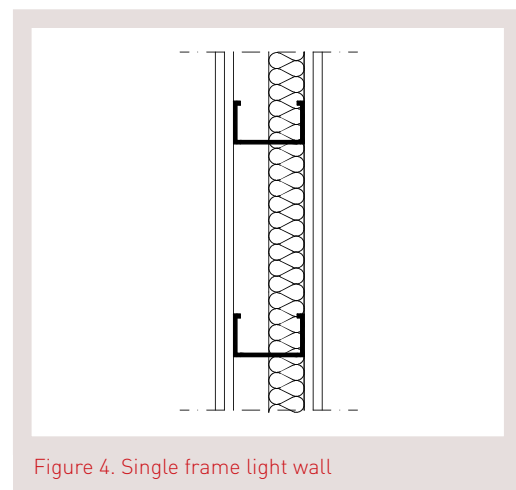
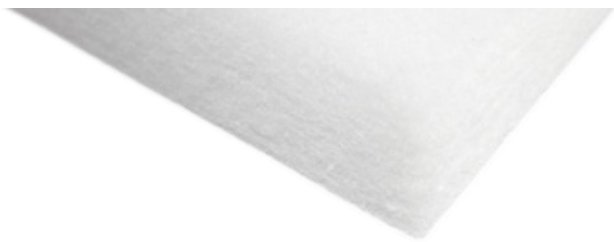



Figure 4. Single frame light wall

→ ISOLMANT FIBRA LC



Insulating panel made of IsolFIBTEC FLC fibre (recycled and thermo-bonded fibre of polyester for technical application). These panels provide high sound and thermal performances/insulation. No-toxic, ecological, with unlimited duration.

Isolmant Fibra LC provides credits for green building certification according to LEED and ITACA rating system.

	 isolmant FIBRA LC
THICKNESS	Approx. 40 - 60 - 80 mm
THERMAL CONDUCTIVITY	$\lambda = 0.039 \text{ W/mK}$
THERMAL RESISTANCE	$R_t = 1.026 \text{ m}^2\text{K/W}$ (40 mm ver)
SPECIFIC HEAT CAPACITY	$c = 1200 \text{ J/kgK}$
VAPOUR RESISTANCE	$\mu = 2$
EQUIVALENT AIR LAYER THICKNESS	$S_d = 0.08 - 0.12 - 0.16 \text{ m}$ (respectively for 40 - 60 - 80 mm versions)
AIRBORNE SOUND INSULATION	$R_w > 50 \text{ dB}$ Cavity wall made of standard bricks without evident acoustic bridges
REACTION TO FIRE	Class 1
SIZE	Panels of $0.6 \text{ m} \times 1.50 \text{ m} = 0.9 \text{ m}^2$
PACKAGING	Packs of 30 - 20 - 15 panels (equal to 27 - 18 - 13.5 m ² each pack) for the 40 - 60 - 80 mm version respectively
TRANSPORT DATA	Packs of $1.20 \text{ m} \times 1.50 \text{ m} \times 0.60 \text{ m}$ weight 22 kg - volume 1.08 m ³

n. 64 = 1728 - 1152 - 864 m²

n. 30 = 810 - 540 - 405 m²



→ Conditions of use

Isolmant Fibra LC is a versatile product. It is recommended for acoustic and thermal insulation of masonry cavity wall or drywall that are perimeter partition and between different dwelling units. Isolmant Fibra LC is conceived for applications inside cavity walls that are made of standard blocks and without evident acoustic bridges, to provide a better airborne sound insulation (higher than 50 dB).

→ ISOLMANT PERFETTO CG

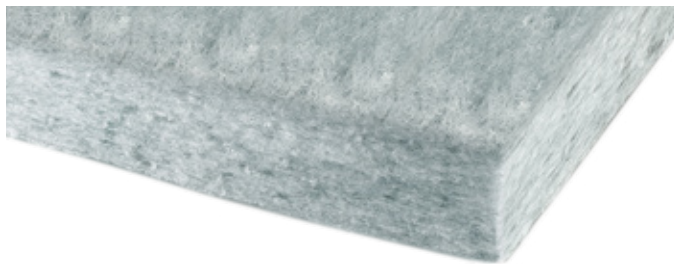

Insulating panel made of IsolFIBTEC PFT fibre (recycled fibre of polyester for technical application with increasing density along the thickness). These panels provide a high sound and thermal insulation. Non-toxic, ecological, with unlimited duration.

Isolmant Perfetto CG provides credits for green building certifications according to LEED or ITACA rating systems.

	 isolmant PERFETTO CG
THICKNESS	Approx. 25 - 45 mm Upon request (at least 500 m ² and within 20 working days in advance), it is also possible to have products with no standard thickness and height
AIRBORNE SOUND INSULATION	$R_w = 55 \text{ dB}$ Value certified False wall with 8 cm hollow brick and metal structure, double plaster board and 45 cm Perfetto CG in the cavity
THERMAL CONDUCTIVITY	$\lambda = 0.038 \text{ W/mK}$
THERMAL RESISTANCE	$R_t = 0.658 \text{ m}^2\text{K/W}$ (25 mm version) $R_t = 1.184 \text{ m}^2\text{K/W}$ (45 mm version)
SPECIFIC HEAT CAPACITY	$c = 1200 \text{ J/kgK}$
EQUIVALENT AIR LAYER THICKNESS	$S_d = 0.05 - 0.09 \text{ m}$ (25 and 45 mm versions respectively) - ($\mu = 2$)
REACTION TO FIRE	Euroclass B-s2,d0
SIZE	Panels of $0.6 \text{ m} \times 1.00 \text{ m} = 0.6 \text{ m}^2$
PACKAGING	Packs of 30 - 20 panels (equal to 18 - 12 m ² each pack) for 25 - 45 mm versions respectively
TRANSPORT DATA	Version 25 mm Packs of $0.6 \text{ m} \times 1.00 \text{ m} \times 0.75 \text{ m}$ weight 9 kg - volume 0.45 m ³ Version 45 mm Packs of $0.6 \text{ m} \times 1.00 \text{ m} \times 0.9 \text{ m}$ weight 10.8 kg - volume 0.54 m ³

Version 25 mm → n. 132 = 2376 m²

n. 60 = 1080 m²

Version 45 mm → n. 96 = 1152 m²

n. 43 = 516 m²



→ Conditions of use

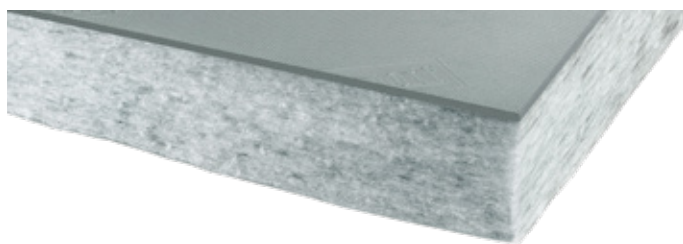

Isolmant Perfetto CG is a versatile product. It is recommended for acoustic and thermal insulation of light partition, drywall, false ceiling and wall. It should be installed into stud spacing and it is suitable to fill partition cavity. It could be also screwed on the partition and then coated. Isolmant Perfetto CG provides the partition with a high airborne insulation and a low thermal transmittance.

→ ISOLMANT PERFETTO SPECIAL (EX BV)



Insulating panel made of IsolFIBTEC PFT (recycled fibre of polyester for technical application with increasing density along the thickness. This fibre has high thermal and acoustic performance) bonded to 5 mm Isolmant Special. Non-toxic, ecological, with unlimited duration. This product comes with overlaps.

Isolmant Perfetto Special (ex BV) provides credits for green buildings certifications according to LEED or ITACA rating systems..

	<div><div></div><div></div></div>
THICKNESS	Approx. 30 - 50 mm (stored) Upon request (at least 500 m² and within 20 working days in advance), it is also possible to have products with no standard thickness and height
AIRBORNE SOUND INSULATION	R _w = 54 dB Value certified Double wall with 8 and 12 cm hollow brick (3 plasters) and 30 mm Isolmant Perfetto BV in the cavity
THERMAL CONDUCTIVITY	λ = 0.035 W/mK (this value refers to the fibre layer) λ = 0.035 W/mK (this value refers to the polyethylene)
THERMAL RESISTANCE AND SPECIFIC HEAT	R _t = 0.857 m²K/W c = 1300 J/kgK (30 mm version) R _t = 1.429 m²K/W c = 1293 J/kgK (50 mm version)
VAPOUR RESISTANCE	μ = 3600 (this value refers to the polyethylene layer)
EQUIVALENT AIR LAYER THICKNESS	S _d = 18 m
SIZE	Panels of 1.00 m x 2.85 m = 2.85 m² Upon request (at least 500 m² within 20 working days), it is also possible to have products with no standard height
PACKAGING	Packs of 10 - 7 panels (equal to 28.5 - 19.95 m² each pack) for 30 - 50 mm versions respectively
TRANSPORT DATA	Version 30 mm Packs of 2.85 m x 1.00 m x 0.30 m weight 37 kg - volume 0.855 m³ Version 50 mm Packs of 2.85 m x 1.00 m x 0.35 m weight 39 kg - volume 0.997 m³

Version 30 mm → n. 56 = 1596 m² n. 28 = 798 m²
 Version 50 mm → n. 48 = 957.6 m² n. 24 = 478.8 m²



→ Conditions of use

Isolmant Perfetto Special is a versatile product. It is recommended for acoustic and thermal insulation of cavity wall cavity wall both perimeter walls and partitions between different dwelling units. Isolmant Perfetto Special can be dry laid between the two leaf wall (if necessary it can be glued or screwed). This product ensures a high airborne sound insulation even in case of dry or false wall.

→ CAVITY WALL

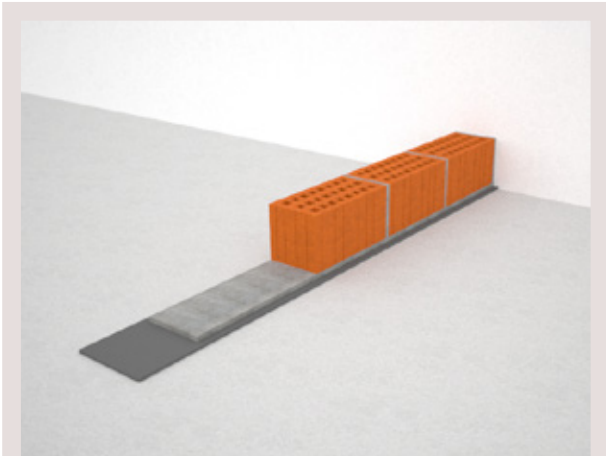

1. When the wall leaves rest on a continuous slab connecting different dwellings, an elastic layers (Isolmant Fascia Tagliamuro) should be placed on top and bottom of each leave/wall, as well as in the junctions with the abutting walls, to reduce flanking transmission. Dry lay the acoustic strip Isolmant Fascia Tagliamuro under the wall and before the first bed of mortar upon which a brick is laid.

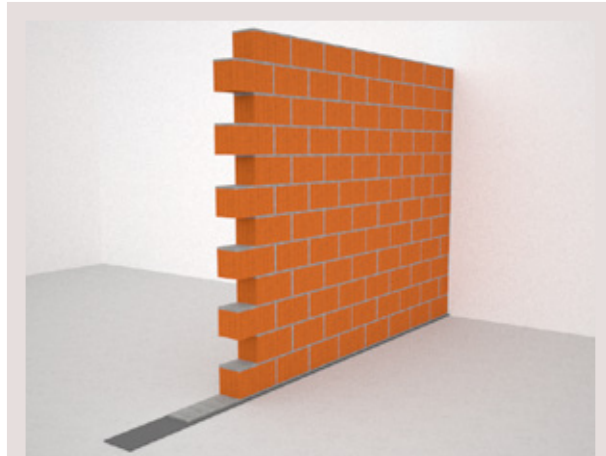

2. Mortar beds and perpends should be always filled with mortar to avoid acoustic bridges.

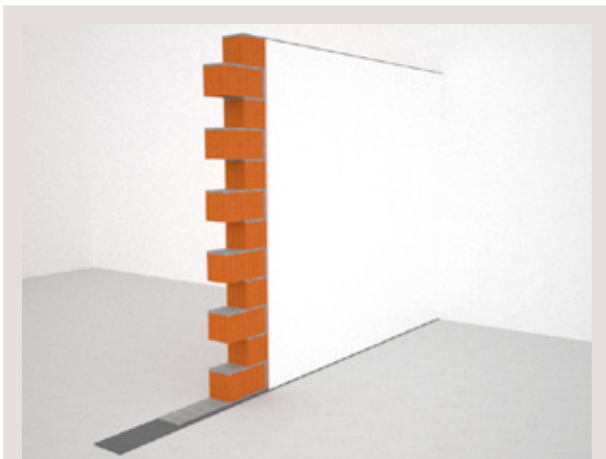

3. A layer of heavy plaster on the inner side of the cavity can reduce acoustic leakage due to workmanship error, such as lack of mortar in vertical joints. Disparity of surface mass for the two leaves (recommended 20 Kg/m²) allows their resonance and coincidence frequency to diverge, ensuring a better airborne insulation.

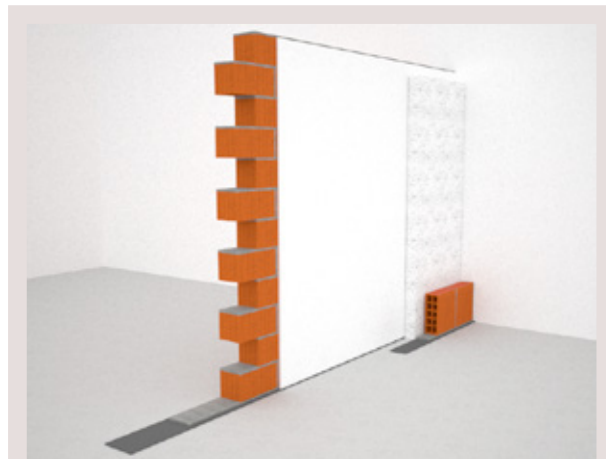

4. While constructing the wall leaves, mortar may drop and debris may fall down to the base of the cavity. The collection of mortar at the base of the cavity wall (at ground floor) creates a strong acoustic bridge: the cavity should be kept clean.

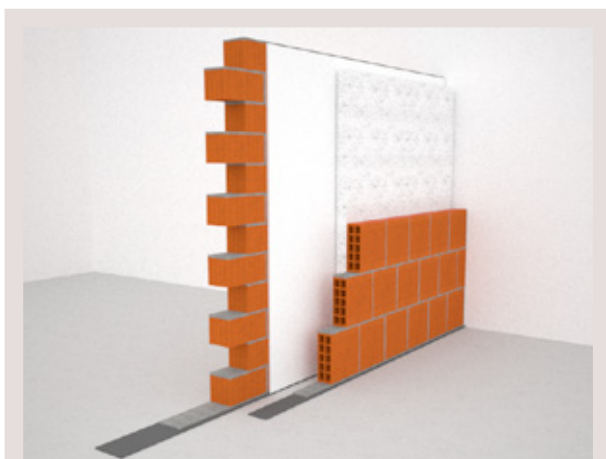

5. It is important that a porous material such as Isolmant Fiber LC or Isolmant Polimuro is installed in the cavity both for thermal insulation and for airborne sound insulation, as it absorbs the cavity resonance of the inner air gap. Sound absorbing material should be installed continuously in the cavity.

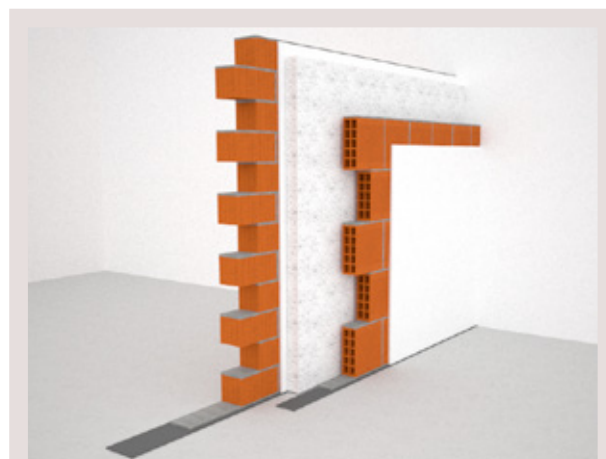

6. Avoid the symmetrical installation of electrical boxes (not staggered) on both sides of the wall.

→ FALSE WALL

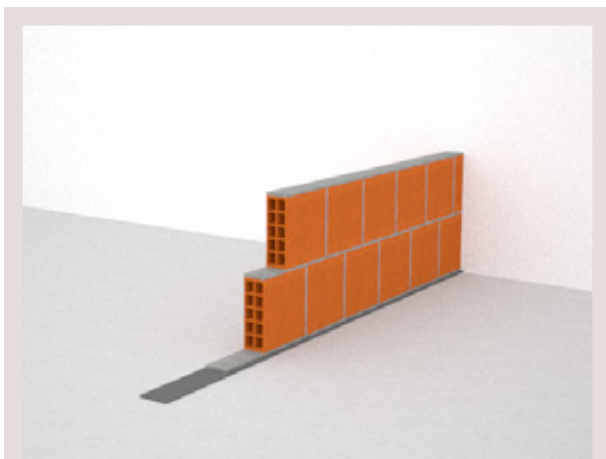

1. Dry lay the acoustic strip Isolmant Fascia Tagliamuro under the wall and before the first bed of mortar upon which a brick is laid. Mortar beds and perpends should be always filled with mortar to avoid acoustic bridges. A layer of heavy plaster on the inner side of the cavity can reduce acoustic leakage due to workmanship error, such as lack of mortar in vertical joints.

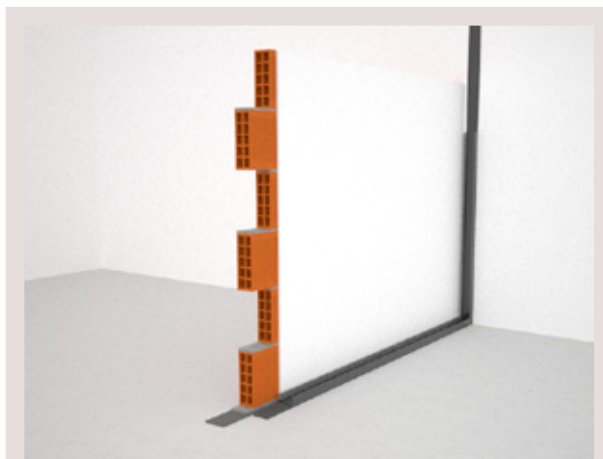

2. The stud construction is connected all around to the flanking building components. Steel frames must not be directly connected with walls and floor: a resilient material should be used. Insulating material such as Isolmant Oditura Cartongesso can be fitted to the webs of runners. Failure to use a resilient material may result in a loss of decibels through the acoustic bridge that is created between the steel frame and the structural/building elements.

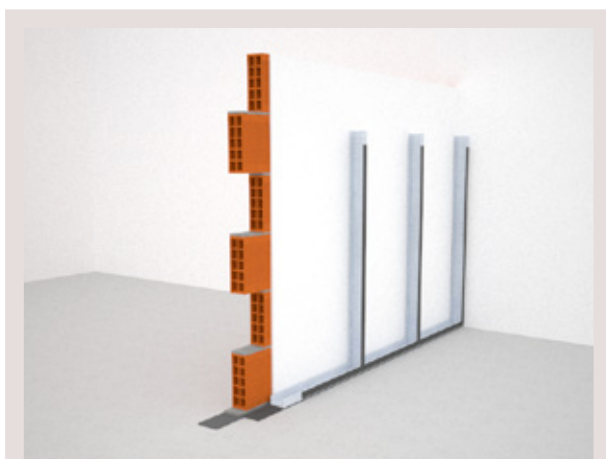

3. Joint design greatly influences the sound insulation of lightweight walls. The same polyethylene foam tape should be used to disconnect the steel frame from plasterboard walls.

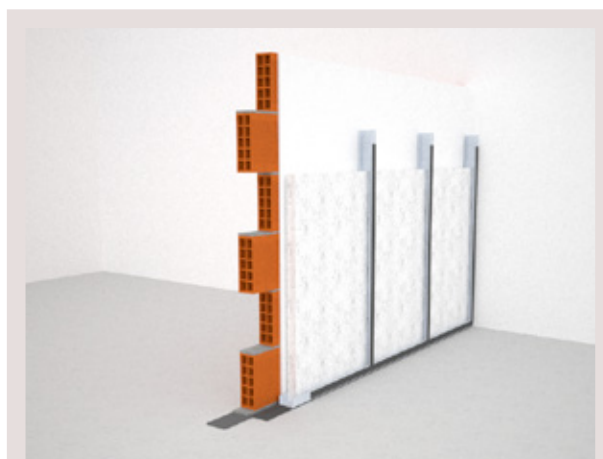

4. Isolmant Fibra LC should be placed into the cavity between the steel frame structures and then coated with plasterboard panels. In the cavity, a porous material such as Isolmant Fiber LC guarantees both thermal insulation and airborne sound insulation, as it absorbs the cavity resonance of the inner air gap. Sound absorbing material should be installed continuously in the cavity.

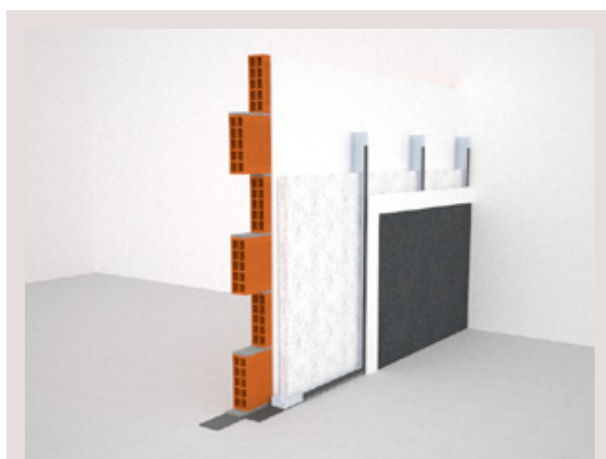

5. A layer of Isolmant Telogomma can be installed between two plasterboards in order to reduce the resonance frequency and to improve low frequency insulation performances. Joints should be staggered in multiple layer applications.

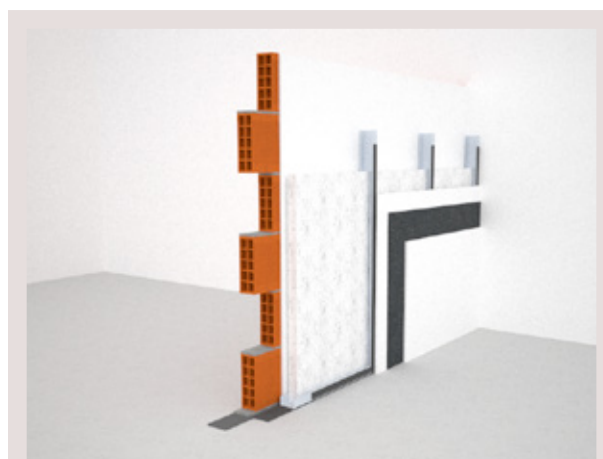

6. Multiple plasterboard leaves should be installed with staggered recessed edges between layers and on the opposite sides of the wall. When jointing, paper tape should be bedded into the compound giving a stronger joint.

→ ISOLMANT ISOLTILE

IsolTile is high density polypropylene soundproofing against footfall, designed to be glued under ceramic flooring.

Used in the renovation of existing floors, it guarantees acoustic improvement of the level of footfall both when replacing ceramic or wooden flooring and when laying over existing flooring. It is ideal in the creation of new floors and, in combination with a floating floor, it allows excellent results in terms of soundproofing against footfall, even in the most complicated situations.

Advantages:

- Renovation of an existing floor as regards acoustics
- Contribution to soundproofing against footfall
- Reducing the risks of breakage of ceramic tiles when these are laid on screeds with limited thickness or which are damp or not particularly firm
- Wooden floorings of all kinds and sizes can be floating or semi-floating on Isolmant IsolTile



Base slab
Levelling screed
Isolmant IsolTile
Finishing

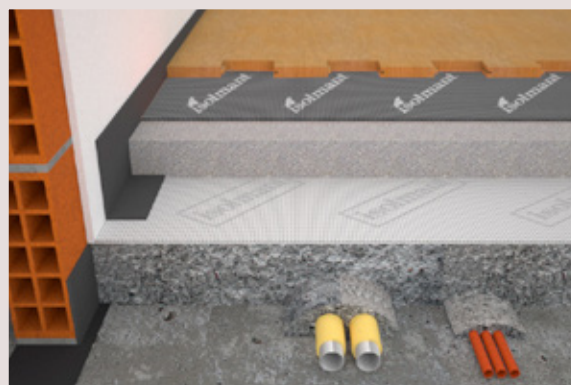

Base slab
Levelling screed
Isolmant Underscreed
Screed
Isolmant IsolTile
Wooden Flooring

Particular Application

Isolmant Kit Scale comes with standard shape sheets of IsolTile that can be cut according to the actual size of treads and risers and stair landings. This kit includes all necessary accessories such as adhesive tape to seal the sheets and flanking strips for disconnecting walls and stairs, both fundamental to perform the acoustic insulation of stairs.

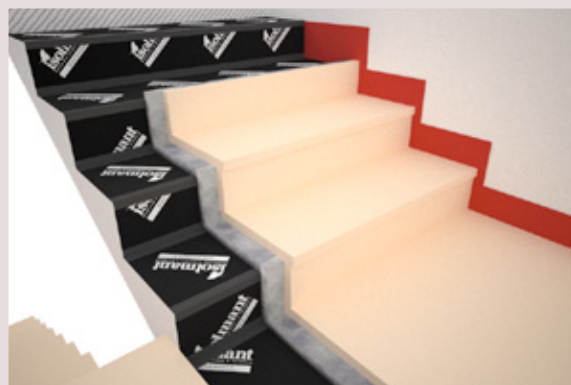



Base structure
Mortar
Isolmant IsolTile
Mortar
Finishing



→ ISOLTILE

IsolTile is a low thickness undertile acoustic layer, designed to the acoustic refurbishment of new or existing floor. This product can be directly laid under ceramic or wooden flooring. IsolTile is made of HD expanded polypropylene (77 kg/m³), calendered-coated by FIBTEC XP1 on both sides. FIBTEC XP1 is non-woven, embossed, black polypropylene.

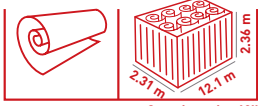
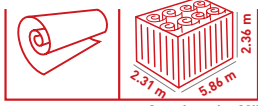
	 
THICKNESS	Approx. 2 mm
IMPACT SOUND INSULATION	$\Delta L_w = 16$ dB Certified value
THERMAL CONDUCTIVITY	$\lambda = 0.037$ W/mK
THERMAL RESISTANCE	$R_t = 0.054$ m ² K/W
EQUIVALENT AIR LAYER THICKNESS	$S_d = 30$ m
COMPRESSIVE STRENGTH	10% compressive deformation at 151 kPa 25% compressive deformation at 180 kPa 40% compressive deformation at 222 kPa 50% compressive deformation at 274 kPa
SIZE	Rolls of: 1 m x 20 m = 20 m ²
PACKAGING	Single rolls with accessories (sealing tape and flanking strip)
ACCESSORIES	Sealing strip: h 7.5 cm x L 20 m Flanking strip: h 3 cm x L 20 m
TRANSPORT DATA	Roll size 1.03 m x 20 m (h x L) = 20 m ² Ø 0.31 m - weight 5.8 kg - volume 0.099 m ³ n. 650 = 13000 m² n. 310 = 6200 m² <div style="display: flex; justify-content: space-around; align-items: center;"> <div style="text-align: center;">  <p>Container size 40"</p> </div> <div style="text-align: center;">  <p>Container size 20"</p> </div> </div>

→ Conditions of use

IsolTile can be installed directly on the existing flooring where acoustic bridges and flanking paths are critical in terms of compliance with the standards in force. It ensures a significant improvement of impact sound insulation with ceramic tiles and wooden flooring as well. It could be also installed on floating screed to enhance acoustic performances. These sheets installation does not modify the standard procedure to lay the flooring. Isoltile does not need any special adhesive that could be selected referring to the installation surface and finishing type. For instance, IsolTile could be laid by means of C2 class compounds for tiles or bi-component epoxypolyurethane glues for wooden flooring.

→ ISOLMANT TELOGOMMA

Isolmant Telogomma is a 2 mm EPDM sheet with high density (4 kg/mq) and high damping characteristics, which is suitable for many applications. The main acoustic property of Telogomma is the high insulation it provides against sound and vibration spread both in air and in structures.

Isolmant Telogomma is designed to be laid free or glued on other materials, in order to improve mass and vibration mitigation. EPDM provides superior properties for outdoor and high temperature applications. The use of Telogomma increases acoustic insulation of light structures, like gypsum boards and wooden floors, mainly at low frequencies.

Isolmant Telogomma has low compressibility and it does not deform under constant stress or pressure, so it is appropriate to support typical building loads.

Advantages:

- High density
- High damping
- VOC free (certified)
- Low thickness
- Good drapability

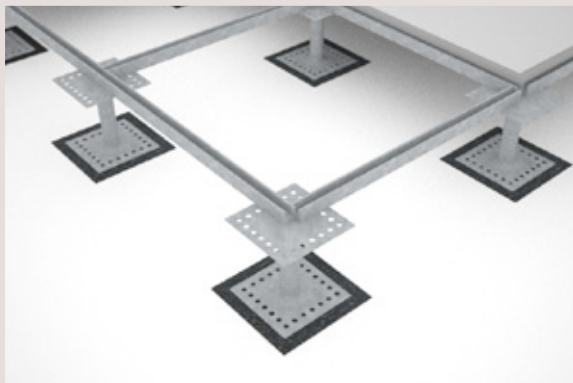

Isolmant Telogomma under raised floor

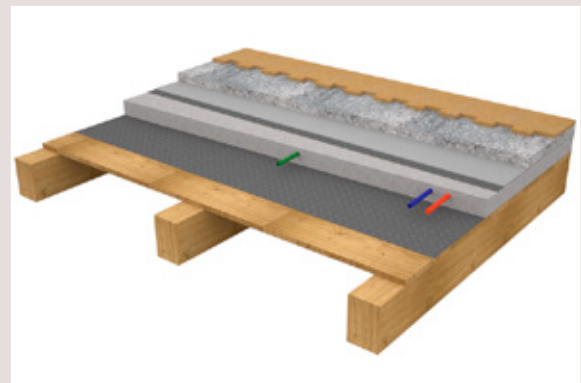

Wooden floor
Isolmant TeloGomma
Levelling screed
Underscreed Isolmant
Screed
Finishing

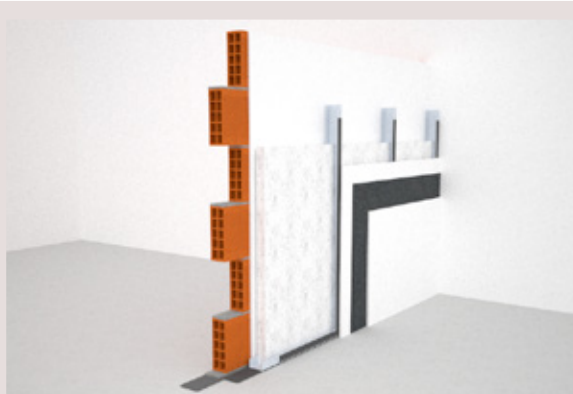

Brick wall
Plaster
Isolmant Fibra LC
Plasterboard
Isolmant TeloGomma
Plasterboard

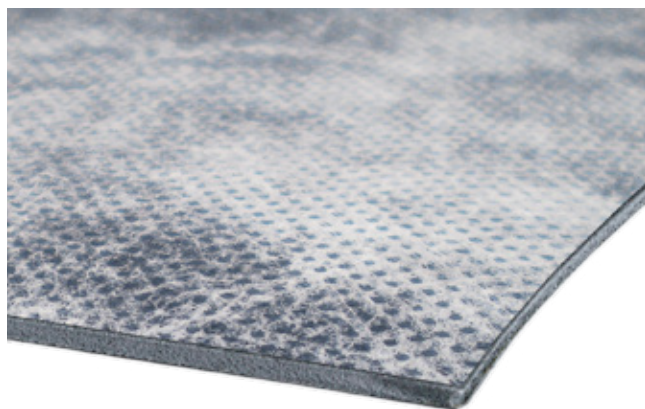

→ ISOLMANT TELOGOMMA

Visco-elastic mass made of a special blend of EPDM rubber with mineral fillers (surface density 4 kg/m² or 5 kg/m²). This acoustic membrane is coated on both sides with non-sticky non-woven fabric. Isolmant TeloGomma is recommended for the airborne sound insulation and vibration isolation of drywalls, masonry walls, plates, fibreglass, plastics and plywood. Upon request, it is possible to have this product with one adhesive side.



isolmantTeloGomma

THICKNESS	Approx. 2 mm Approx. 2,5 mm
WEIGHT	Approx. 4 kg/m ² Approx. 5 kg/m ²
AIRBORNE SOUND INSULATION	R _w = 29 dB Certified value Normal incidence sound transmission loss test with rubber of 4 kg/m ²
VAPOUR RESISTANCE	μ = approx. 7000
SIZE	Rolls of 1 m x 3 m (h x L) = 3 m ²
PACKAGING	30 rolls pallet (equal to 90 m ²)
TRANSPORT DATA	<p>Pallet size 1.16 m x 0.80 m x 0.60 m weight 370 kg - volume 0.5568 m³</p> <div> <div> <p>n. 72 = 6480 m²</p> <p>Container size 40'</p> </div> <div> <p>n. 50 = 4500 m²</p> <p>Container size 20'</p> </div> </div> <p>Total amount of product depending on the container payload</p>

→ Conditions of use

The material can also be used on uneven surfaces. May be cut or punched. The viscoelastic mass is suitable for increasing air-born sound insulation of lightweight wall, for vibration isolation of metal sheets and for damping the vibrations of mechanical parts in general.



Antonini Tower – Milan



Lombardia Region Headquarters – Milan



“Bosco Verticale” – Milan



Piemonte Region Headquarters - Turin



Theatre Arcimboldi – Milan



San Siro Stadium – Milan



Pavillon 0 – Expo 2015 – Milan



Pavillon Mexico – Expo 2015 – Milan



Housing Estate – Assago – Milan



cod. Articolo D013COMMENG **isolmant** is a Tecnasfalti srl registered brand. All brands in the catalogue are protected © TECNASFALTI
All rights reserved - Any reproduction, even partial, is prohibited - In force as of January, 2017. Replaces and supersedes all previous editions

TECNASFALTI Srl | Via dell'Industria, 12 Loc. Francolino 20080 Carpiano (Milan)
Tel+39029885701 | Fax+390298855702 | clienti@isolmant.it | www.isolmant.com